

Installing a Wireless Printer at Home

This document explains how to install a home wireless printer on a Windows computer.

1. In the search bar, type **print**.
2. Select **Add a printer or scanner**.

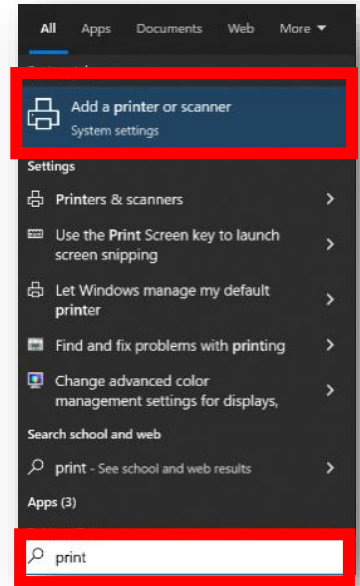

3. Select **Add printers and scanners**.

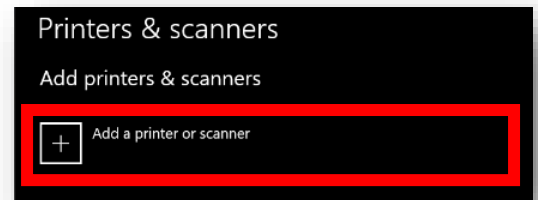

4. Select the **wireless printer** you would like to add and follow the prompts.
Note: All available wireless printers recognized by the device will appear below Refresh icon on the screen.

